

1250LB ATV MESH CART

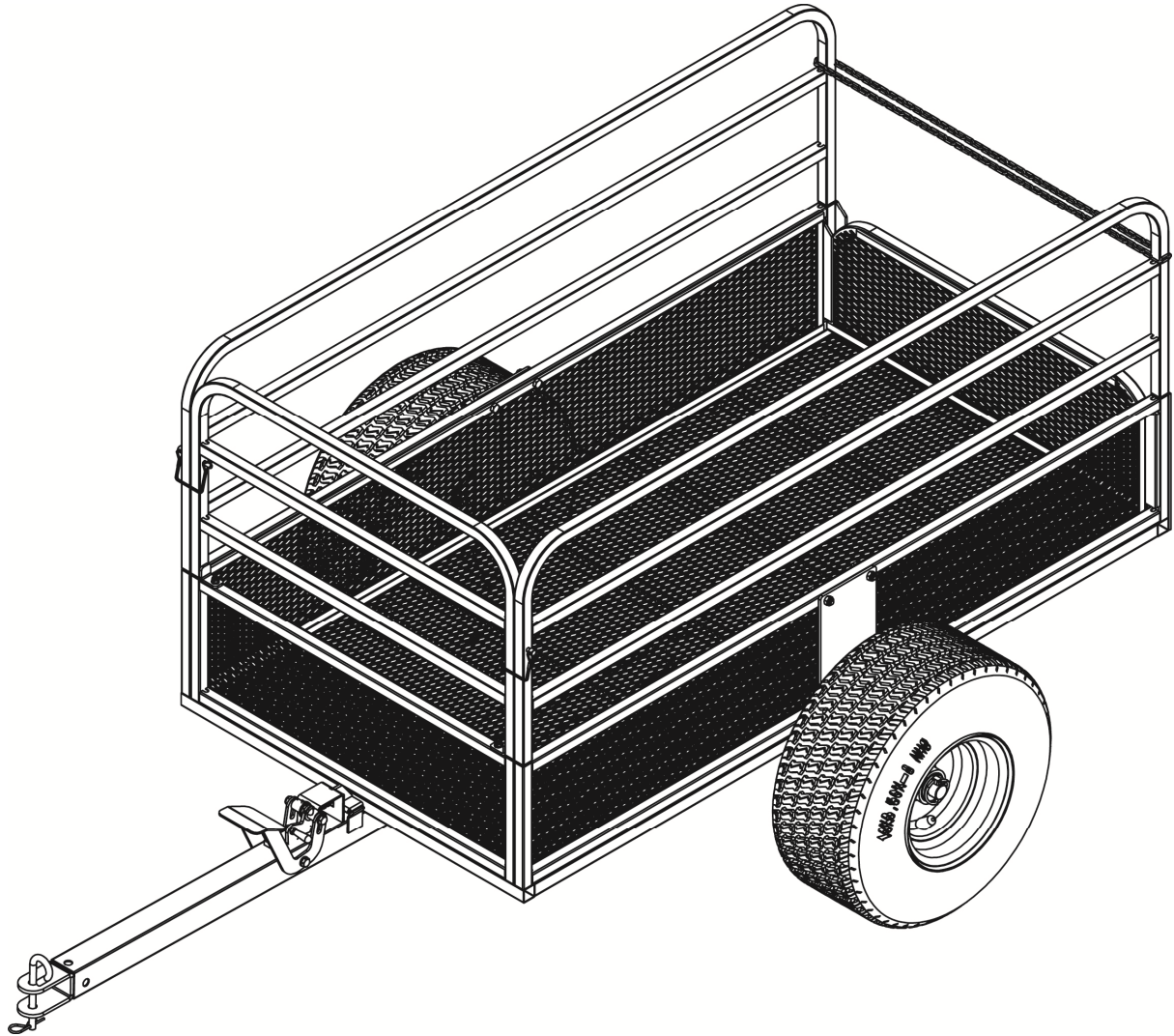

Instruction & Assembly

SAVE THESE INSTRUCTIONS FOR FUTURE REFERENCE

Table of Contents

General Warnings and Rules	3
Controls and Features Identification.....	4
Assembly Instructions	5, 6, 7
Operation Instructions	7, 8
Maintenance and Storage	9
Specification.....	9
Parts Drawing & Parts List	10, 11
Limited Warranty	12

GENERAL WARNINGS

READ and UNDERSTAND this manual completely before using the mesh cart.

Operator must read and understand all safety and warning information, operating instructions, maintenance and storage instructions before operating this equipment. Failure to properly operate and maintain the mesh cart could result in serious injury to the operator or bystanders.

Operation Warnings

- Do not allow children to play on, stand upon or climb on the utility cart.
- Never use the utility cart as a step ladder or scaffolding.
- Always inspect the cart before using to assure it is in good working condition.
- Only use the mesh cart for its intended purpose.
- Always block the wheels when loading and unloading the cart.
- Replace or repair damaged or worn parts immediately.
- Always check and tighten hardware and assembled parts before operation.
- Do not exceed equipment maximum load capacity of 1250LB (567KG).
- Always use caution when operating the flatbed cart.

Crush and Cut Hazards

- Always keep hands and feet clear from moving parts while operating the equipment.
- Always clear and keep work area clean when operating.
- Always wear safety gear, eye protection, gloves and work boots when using the cart.

WARNING

The warnings, cautions, and instructions outlined in this instruction manual cannot cover all possible conditions or situations that may occur. It must be understood by the operator that common sense and caution are factors which cannot be built into this product and must be supplied by the operator.





PROP 65 WARNING

This product can expose you to chemicals including lead and lead compounds which are known to the State of California to cause cancer and birth defects or other reproductive harm. For more information, go to www.P65Warnings.ca.gov.

Assembly Is Required

This product requires assembly before use. See "Assembly" section for instructions. Because of the weight and/or size of the utility cart, it is recommended that another adult be present to assist with the assembly. **INSPECT ALL COMPONENTS** closely upon receipt to make sure no components are missing or damaged.

Hazard Signal Word Definitions

	<p>This is the safety alert symbol. It is used to alert you to potential personal injury hazards. Obey all safety messages that follow this symbol to avoid possible injury or death.</p>
	<p>DANGER indicates an imminently hazardous situation which, if not avoided, will result in death or serious injury.</p>
	<p>WARNING indicates a potentially hazardous situation which, if not avoided, could result in death or serious injury.</p>
	<p>CAUTION indicates a potentially hazardous situation which, if not avoided, may result in minor or moderate injury.</p>
	<p>CAUTION used without the safety alert symbol indicates a potentially hazardous situation which, if not avoided, may result in property damage.</p>

ABOUT YOUR UTILITY FLAT BED CART

This utility cart has a steel frame and mesh deck that allows sand, small debris and moisture to drop through. The cart is easy to maneuver and will transport up to 567kg (1250lb) of landscaping materials, potting soil, bricks, stones, industrial equipment, parts, finished products, firewood and more. The powder coat finish is rust resistant and is designed to withstand the outdoor elements. Never exceed the rated load capacity of 1250LB (567KG) when using the cart.

Technical specifications on the flatbed cart are provided in the “Specifications” section of this manual.



CAUTION

Read and follow all instructions for assembly and operation. Failure to properly assemble this equipment could result in serious injury to the user or bystanders, or cause equipment damage.

MESH CART COMPONENT PARTS AND ASSEMBLY

Take all parts out of the shipping crate and inspect components to ensure there are no missing pieces before starting to assemble the mesh cart follow steps 1 through 4.

TOOLS REQUIRED

- 14, 17& 19mm Wrenches

Assembly Instructions

STEP 1:

1. Flip the mesh box over before installing the mounting plates.
2. Attach one axle mounting plate (#30) to one side of the box frame with hex bolt M8x40 (#29) and nylon lock nut M8 (#31).

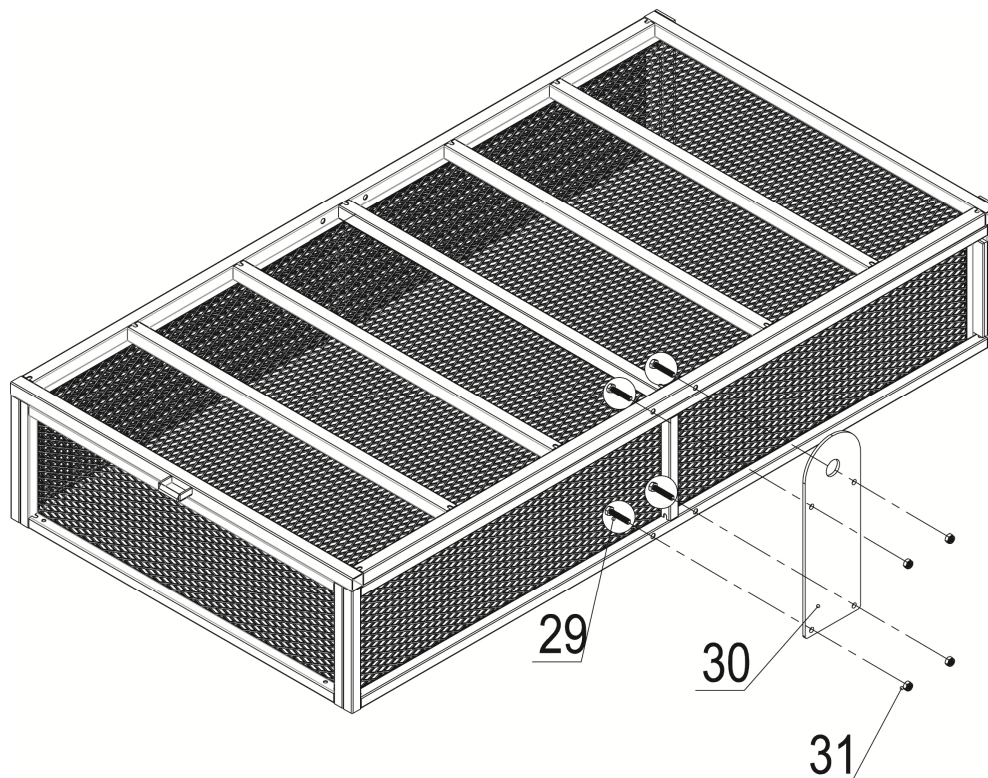

STEP 2:

1. Insert the axle tube (#26) through the axle mounting plate, then attach another axle mounting plate (#30) to the other side of the box frame with hex bolt M8x40 (#29) and nylon lock nut M8 (#31).

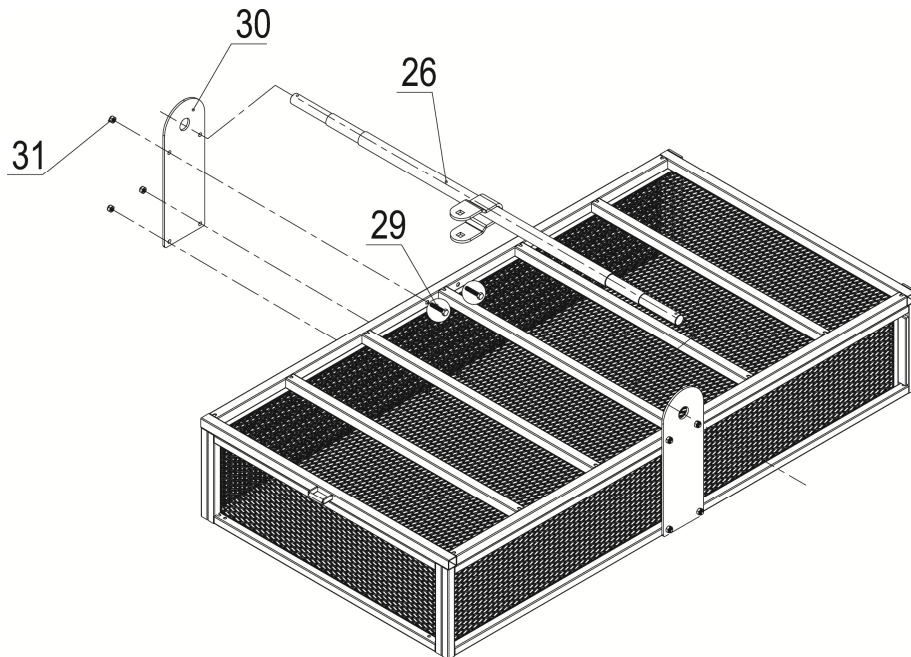

STEP 3:

1. Attach the tongue assembly (#10) to the “u-bracket” on the axle tube using cup head square neck bolt M12x80 (#23), flat washer Ø12 (#27) and nylon lock nut M12 (#28). Lock the tongue to the box frame before installing the wheels
2. Insert the wheel spacer (#6), flat washer Ø12 (#4), wheel (#25), flat washer Ø12 (#4) and o lock ring (#24) over the axle. Repeat steps the other side.
3. Flip the trailer into the upright position and insert hitch pin (#11) and R pin (#12).

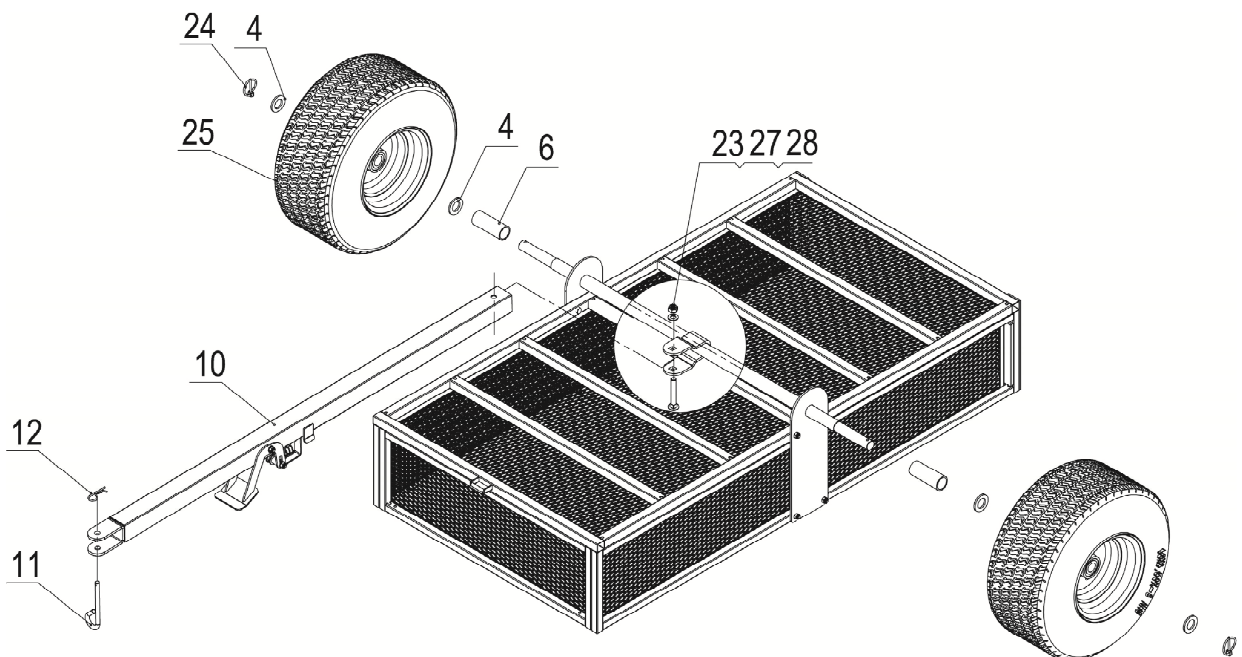

STEP 4:

1. Slide the two side racks (#3) and the front rack (#5) into the corresponding tubes openings on the trailer frame. Insert the removable tailgate (#2) into the channels on the trailer frame.
2. Fix front rack (#5) to the trailer frame using hex bolt M6x35 (#32), flat washer Ø6 (#33) and nylon lock nut M6 (#18).
3. Fix two side racks (#3) to the front rack (#5) using drive pin (#34).
4. Install the chain (#35) to the back of the two side racks (#3).

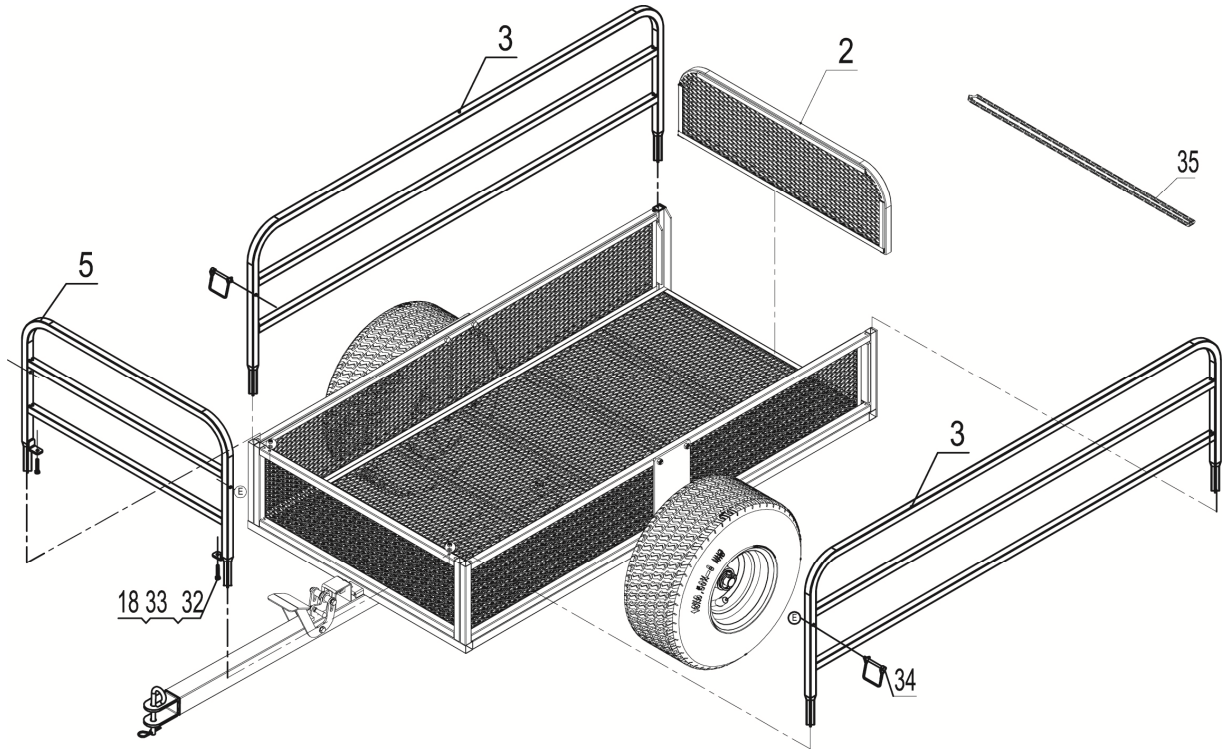

Operation Instructions

WARNING

Before using the mesh cart review the instructions below and safety information. Failure to follow these instructions may result in property damage or injury to the operator or bystanders.

USING YOUR UTILITY CART

1. **DO NOT** exceed equipment maximum load capacity of 1250LB (567KG).
2. **DO NOT** allow children to play on, stand upon or climb on the mesh cart.
3. **KEEP** children and bystanders away from work area when operating machinery or equipment.
4. **NEVER** use the mesh cart as a step ladder or scaffolding.
5. **ALWAYS** inspect the cart before using to assure it is in good working condition.
6. **NEVER** exceed the recommended 28 PSI rating when inflating the tires.
7. **ALWAYS** block the wheels when loading and unloading the cart.
8. **ALWAYS** replace or repair damaged or worn parts immediately.
9. **ALWAYS** check and tighten hardware and assembled parts before operation.
10. **ALWAYS** use caution when operating the utility cart.
11. **DO NOT** operate tools or equipment if under the influence of alcohol or drugs.

Operation Instructions

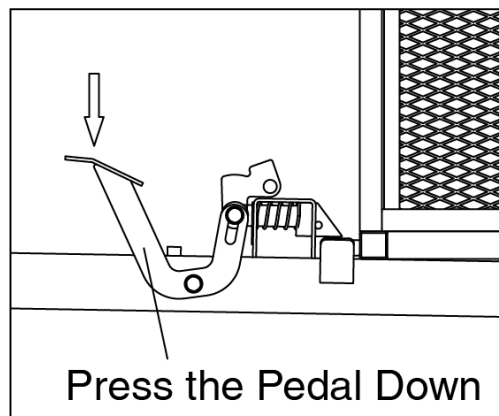
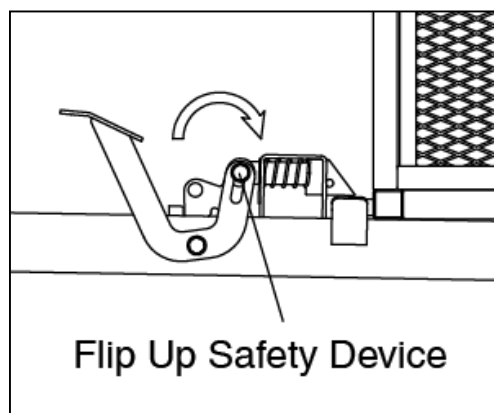
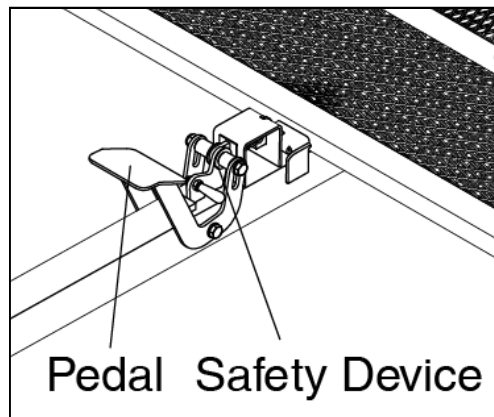

1. Flip up the safety device and press the pedal down to release the bed for dumping.
2. When towing the cart, flip down the safety device to lock the bed to avoid accidental dumping.

Warning: Do not press the pedal after the safety device is locked.

Maintenance and Storage



WARNING

Improper maintenance and storage of the mesh cart may void your warranty.

MAINTENANCE

- Regularly grease the wheel bearing area or when needed.
- Periodically check all fasteners for tightness.
- Annually clean and lightly lubricate all moving parts.
- Use a glossy enamel spray paint to touch up scratched or worn painted metal surfaces.
- Never exceed load capacity rating of 1250LB (567KG) it will damage the mesh cart.

IMPORTANT:

If a part needs replacement, only use parts that meet the manufacturer's specifications. Replacement parts that do not meet specifications may result in a safety hazard or poor operation.

STORAGE

- Never allow material to remain on the mesh cart for extended periods of time.
- Before storing make sure the cart is clean and dry for years of trouble free service.
- Store indoors or protected area during severe weather and winter months.

Specifications

Load Capacity	1250LB (567KG)
Frame Material	Steel
Deck Material	Steel Mesh
Bed Dimensions (L x W x H)	55"x29"x10"
Tire Size	18"
Tires PSI	28

Exploded Drawing & Parts List

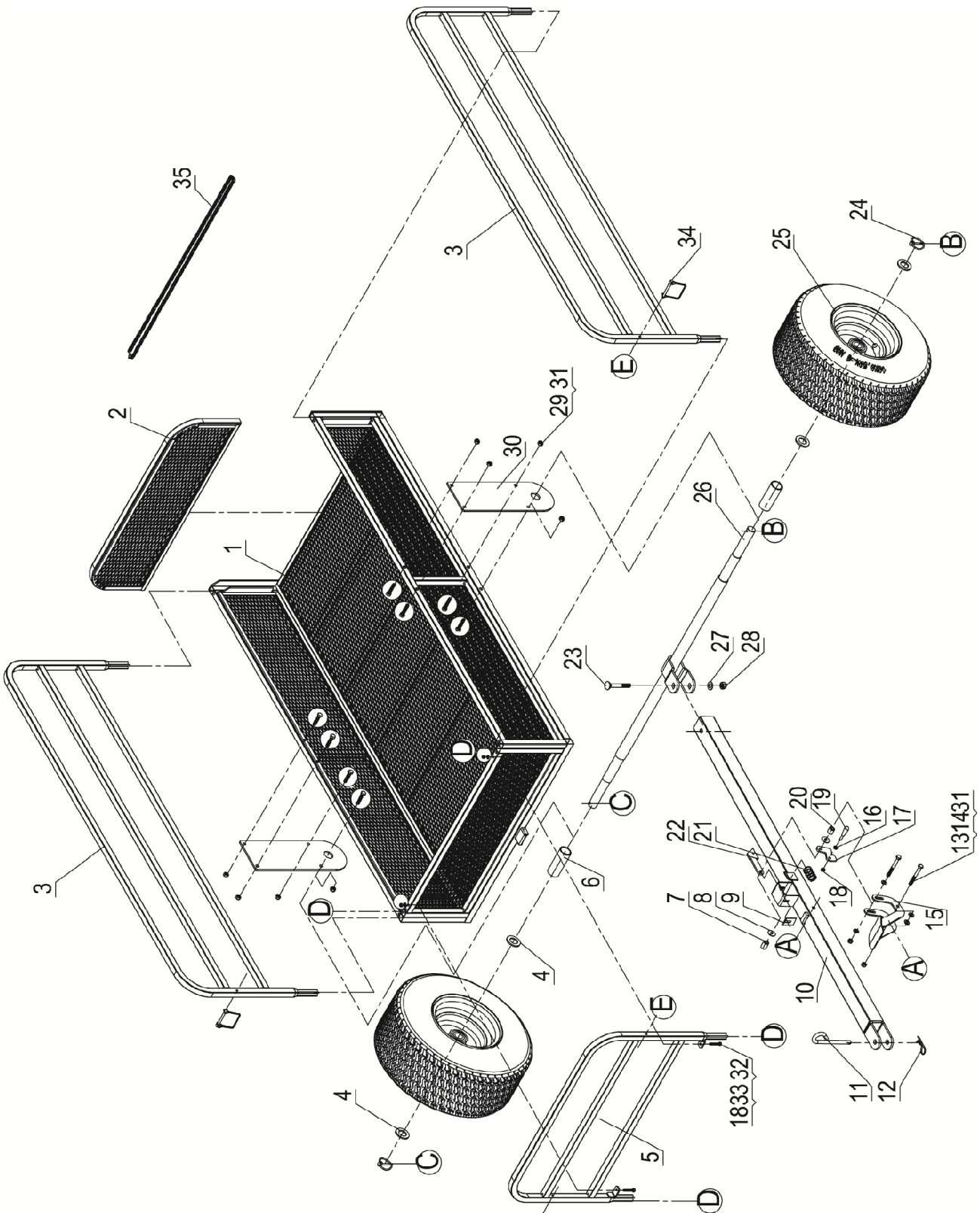

Exploded Drawing & Parts List

Ref#	Drawing No.	Description	Qty
1	DCM1200-01000	Trailer Frame Assembly	1
2	DCM1200-02000	Removable Tailgate	1
3	DCM1200-03000	Slid Containment Rack	2
4	9301-24000-DX	Flat Washer Ø24	4
5	DCM1200-04000	Front Containment Rack	1
6	DCM1200-00002-DX	Wheel Spacer	2
7	DCP0600-00006-DY	Bushing	1
8	9302-08000-DX	Large Flat Washer Ø8	2
9	DCP0600-00004-DX	Spacer	1
10	DCM1200-06000	Tongue Tube	1
11	N870-00011-DX	Hitch Pin	1
12	LSP25-00012-DX	R Pin Ø3	1
13	9101-08075-DX	Hex Bolt M8x75	2
14	9301-08000-DX	Flat Washer Ø8	4
15	DCP0600-04000	Pedal	1
16	9201-06000-DX	Hex Nut M6	1
17	DCP0600-00009-DY	Locking Gasket	1
18	9206-06000-DX	Nylon Lock Nut M6	3
19	DCP0600-00008-DX	Handle	1
20	DCP0600-00010-DY	Bushing A	1
21	DCP0600-00003-DX	Pressure Spring	1
22	DCP0600-00002-DX	Safety Fork	1
23	9114-12080-DX8.8	Cup Head Square Neck Bolt M12x80	1
24	TS600-00009-DX	O Lock Ring	2
25	DCP1200-00002	Wheel	2
26	DCM1200-05000	Axle Tube	1
27	9301-12000-DX	Flat Washer Ø12	1
28	9206-12000-DX	Nylon Lock Nut M12	1
29	9101-08040-DX	Hex Bolt M8x40	8
30	DCM1200-00001	Axle Mounting Plate	2
31	9206-08000-DX	Nylon Lock Nut M8	10
32	9101-06035-DX	Hex Bolt M6x35	2
33	9301-06000-DX	Flat Washer Ø6	2
34	DCM1200-00004	Drive Pin	2
35	DCM1200-00003	Chain	1

Limited Warranty

Warranty

For one year from the date of purchase YTL International will replace for the original purchaser, or repair the flatbed cart. The warranty will not apply to any unit which was not assembled correctly, misused, overloaded or which has been used or operated contrary to our instructions, or which has been repaired or altered by anyone other than an authorized representative.

Warranty Exclusions

This warranty does not cover cosmetic defects such as paint, decals or wear items such as tires. This warranty will not cover failures or problems due to acts of God, or events or forces beyond the control of the manufacturer.

Normal Wear Exclusion

The flatbed cart needs periodic service to perform well. This warranty does not cover repair when normal use has exhausted the life of a part or the equipment as a whole.

Installation, Use and Maintenance Exclusion

This warranty will not apply to parts and/or labor if the flatbed cart has been misused, neglected, involved in an accident, abused, loaded beyond its limits, modified or assembled incorrectly. Normal maintenance is not covered under this warranty.

Limits of Implied Warranty and Consequential Damage Exclusion

YTL International disclaims any obligation to cover any loss of time, use of this product, freight, or any incidental or consequential claim by anyone from using this flatbed cart. THIS WARRANTY IS IN LIEU OF ALL OTHER WARRANTIES, EXPRESS OR IMPLIED, INCLUDING WARRANTIES OF MERCHANTABILITY OR FITNESS FOR A PARTICULAR.

An exchange unit will be subject to the original warranty. The length of the warranty governing the exchanged unit will have the date as the purchase date of the original unit. This warranty gives you certain legal rights which may change from state to state. Your state may also have other rights you may be entitled to that are not listed within this warranty.

Contact Information

YTL International Inc.
17517 Fabrica Way, Suite H
Cerritos, CA 90703
Phone: (888) 723-6534
Phone: (562) 404-8016
Fax: (562) 404-8013
E-mail: parts@ytlinternational.com
Website: www.ytlinternational.com

Warranty & Customer Support Questions
Phone: (888) 723-6534