

# 175LB TOW-BEHIND SPREADER



## Instruction & Assembly

SAVE THESE INSTRUCTIONS FOR FUTURE REFERENCE

## SAFETY RULES

### READ THE DIRECTIONS BEFORE ASSEMBLY

- Read the towing vehicle owners manual and towing vehicle safety rules. Know how to operate your tractor before using the tow-behind spreader.
- Read the chemical label instructions and cautions for handling and applying the chemicals purchased for spreading.
- Wear eye and hand protection when handling and when applying lawn or garden chemicals.
- Never operate tractor and spreader attachment without wearing substantial footwear, and do not allow anyone to ride or sit on spreader attachment frame.
- Never allow children to operate the tractor or spreader attachment, and do not allow adults to operate without proper instructions.
- Always begin with the transmission in first (low) gear and with the engine at low speed, and gradually increase speed as conditions permit.
- When towing spreader do not drive too close to a creek or ditch and be alert for holes and other hazards which could cause you to loose control of the spreader and tractor.
- Before operating vehicle on any grade (hill) refer to the safety rules in the vehicle owner's manual concerning safe operation on slopes. **Stay off steep slopes!**

## REMOVE AND IDENTIFY LOOSE PARTS FROM CARTON AND BAG

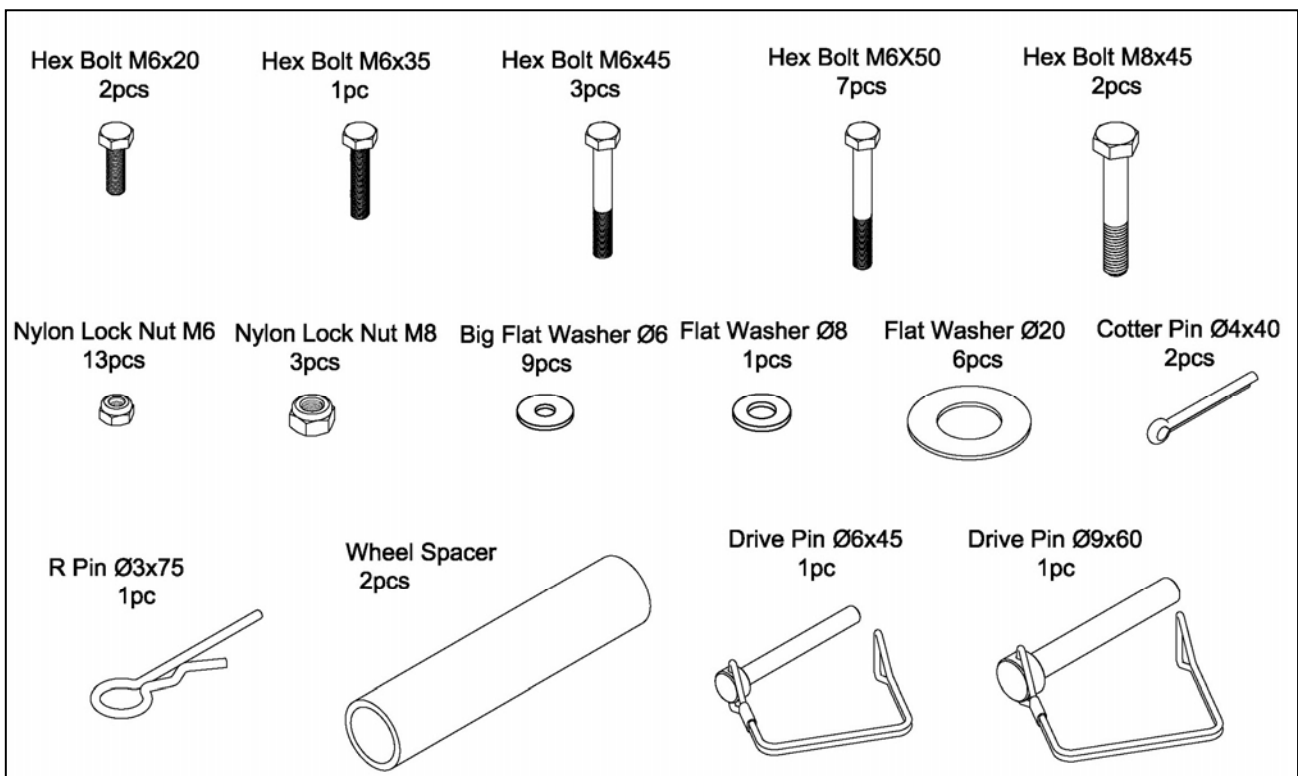

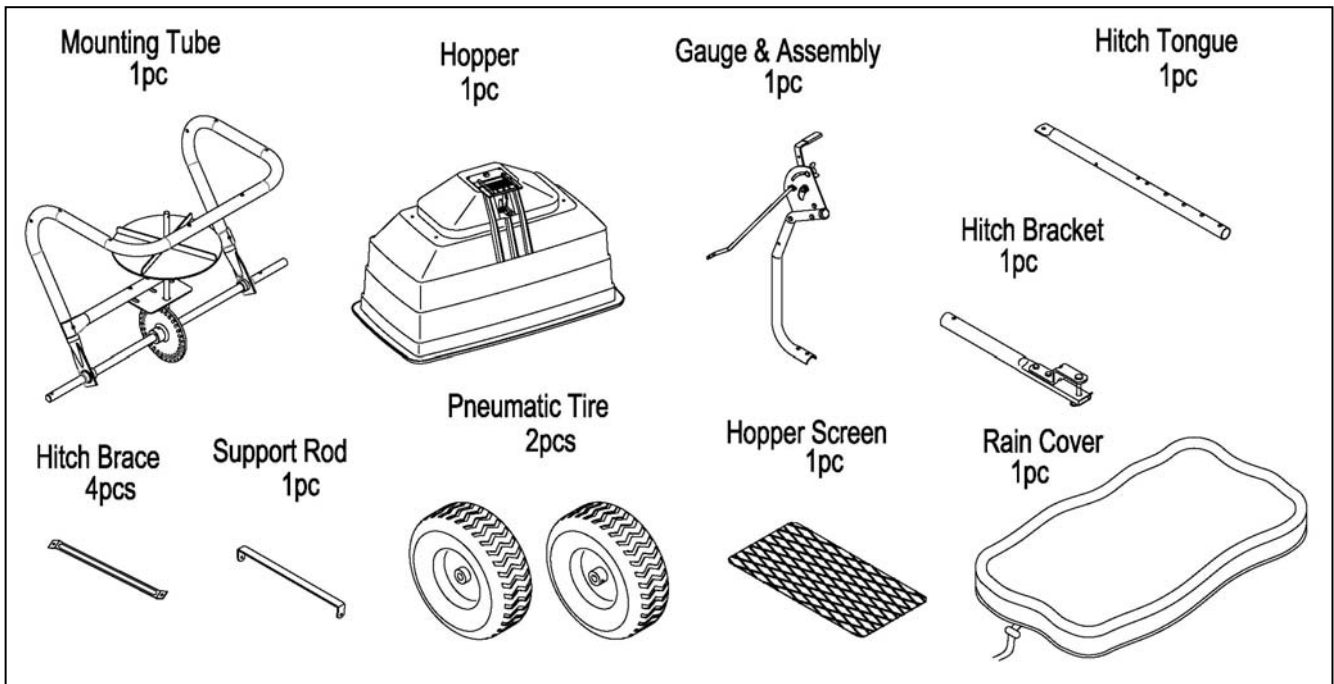

## ASSEMBLY INSTRUCTION

**STEP 1:** In the following order put flat washer Ø20, wheel spacer, second flat washer Ø20, Tire, third flat washer Ø20 on the end of wheel axle. Insert the cotter pin Ø4x40 into the small hole on the axle and bend to secure. Put the Impeller onto the gear box & axle assembly and insert the round head bolt M4x20 through impeller and gear box axle.

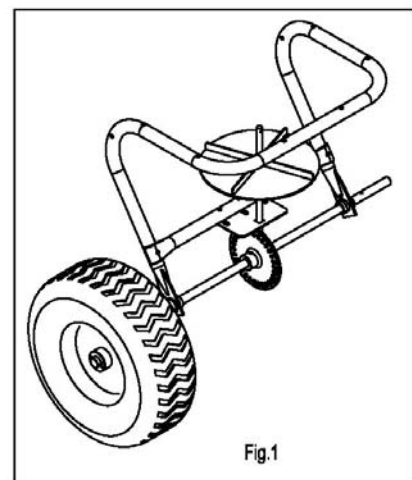
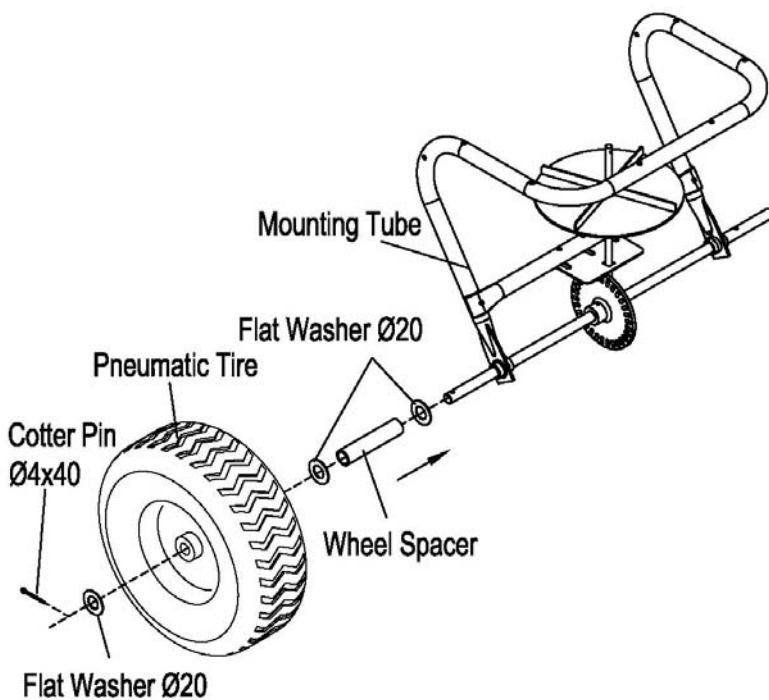

**STEP 2:** On the other side of the wheel axle repeat the same step as above. Rotate the wheel so both the wheel and axle holes align and insert the drive pin  $\text{Ø}6 \times 45$  and lock it. (Attach the Wheel Assembly Frame on each side of the Gear Box Axle and Fixing Connecting Rod),

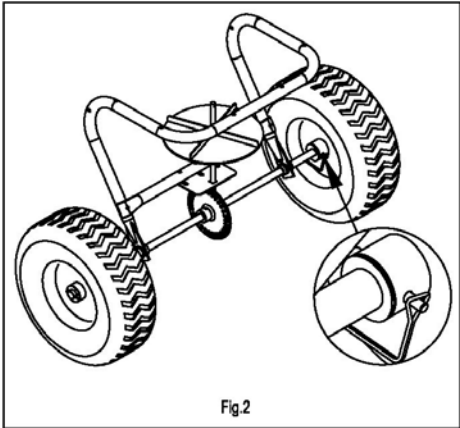
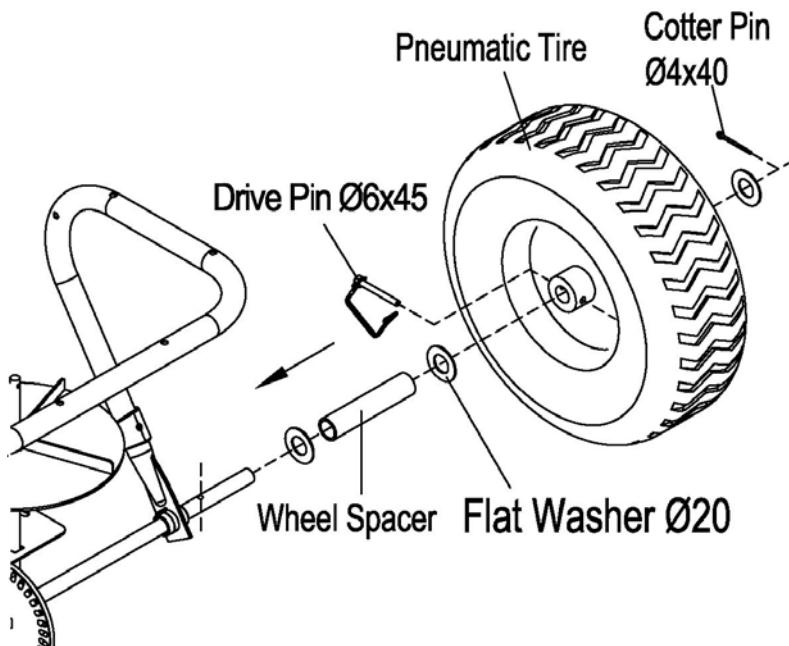

**STEP 3:** Insert the hex bolt  $\text{M}6 \times 50$  after aligning the hole on the flat end of hitch tongue (stay on top) with the one at the middle of crossover tube. Connect using a big flat washer  $\text{Ø}6$  and nylon lock nut  $\text{M}6$  and don't screw it up moderately. Install one end of the connecting plate on the wheel frame using bolt  $\text{M}6 \times 35$  and lock nut  $\text{M}6$ .

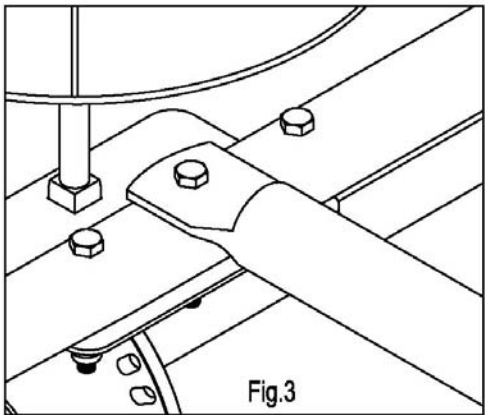
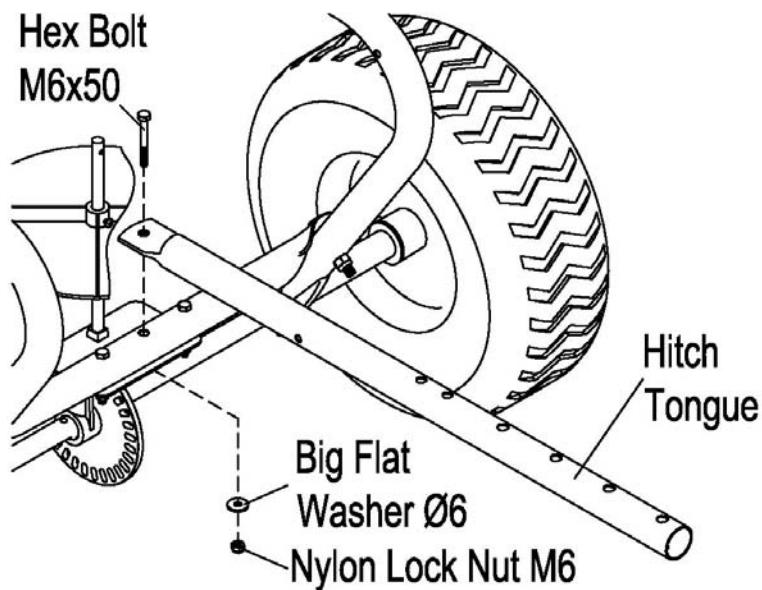

**STEP 4:** Attach the braces on each side of hitch tongue using bolt M6x45 and nylon lock nut M6. Loosely tighten.

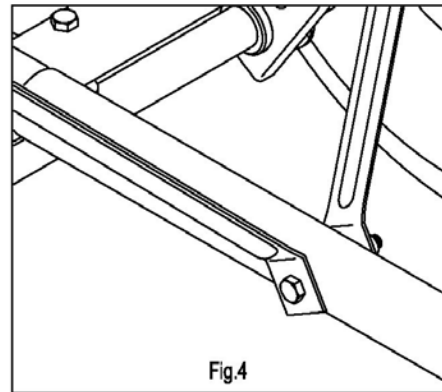
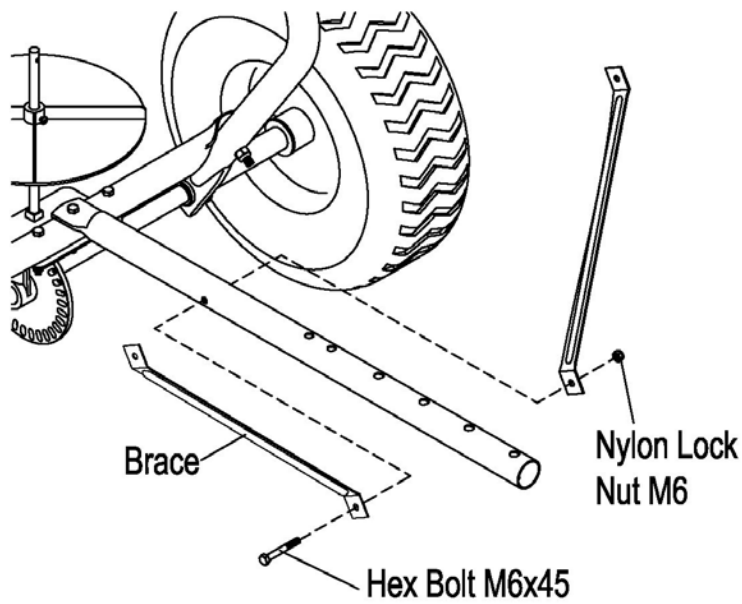

**STEP 5:** Attach the gauge lever assembly to the middle of Hitch Tongue using two hex bolts M8x45 and nylon lock nuts.

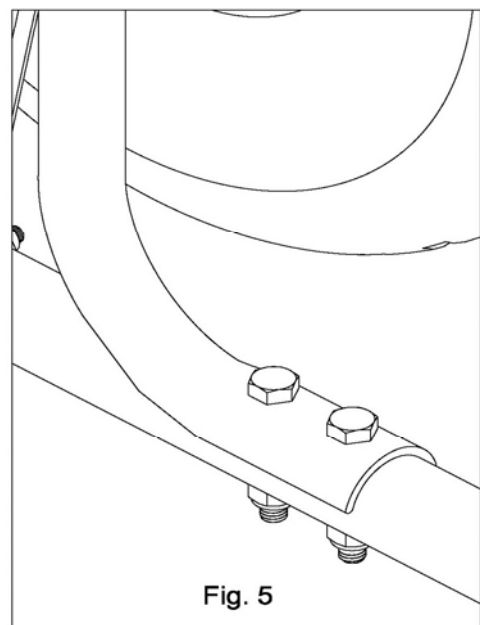
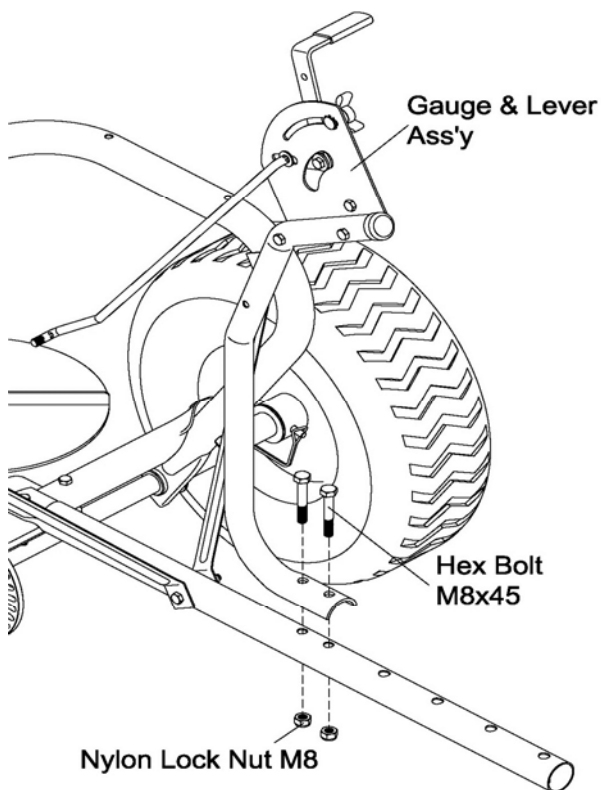

**STEP 6:** 1. Attach the two upper braces on each side of the support rod using hex bolt M6x45 and nylon lock nut M6. Loosely tighten. 2. Connect other end of the braces to the upper mounting tube using bolt M6x45 and nylon lock nut M6. 3. Tighten all hardware.

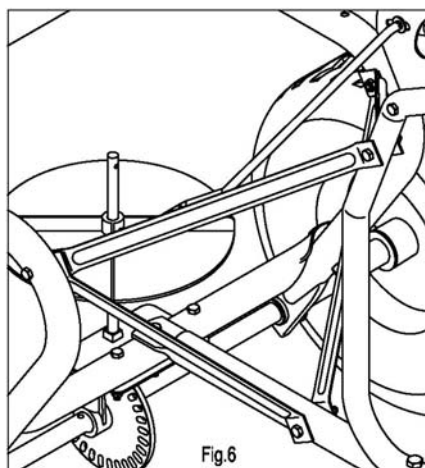
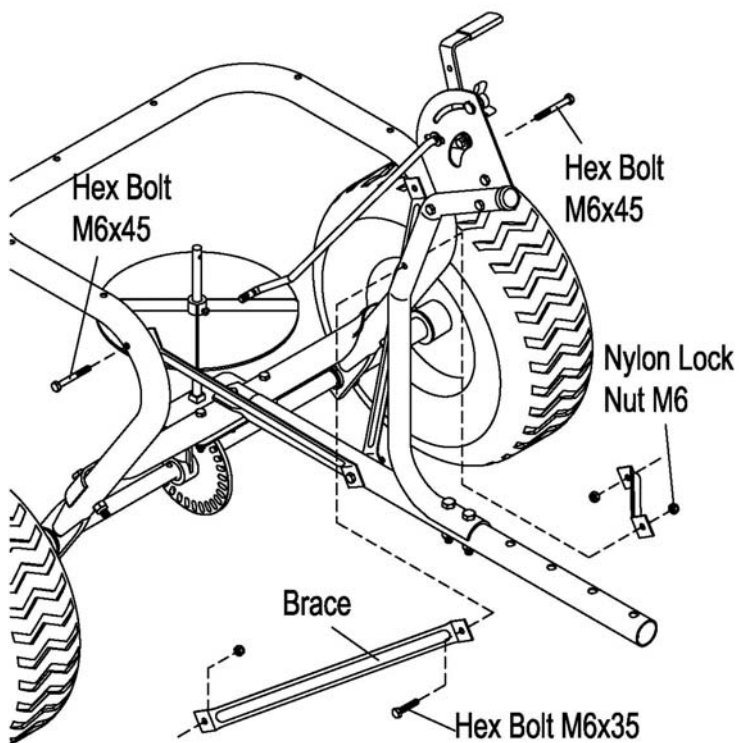

**STEP 7:** 1. Align all the six holes around inside of hopper and frame and attach using bolts M6x50, big flat washer Ø 6 on the top and secure with nylon lock nuts M6 on the bottom. Adjust parts the so the impeller moves freely and tighten the hardware holding the hopper. 2. Insert the R pin Ø3x75 into the hole on the swivel axle.

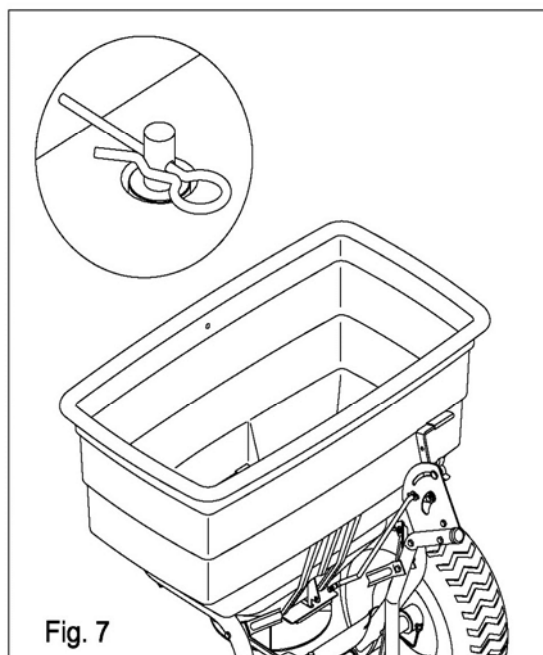
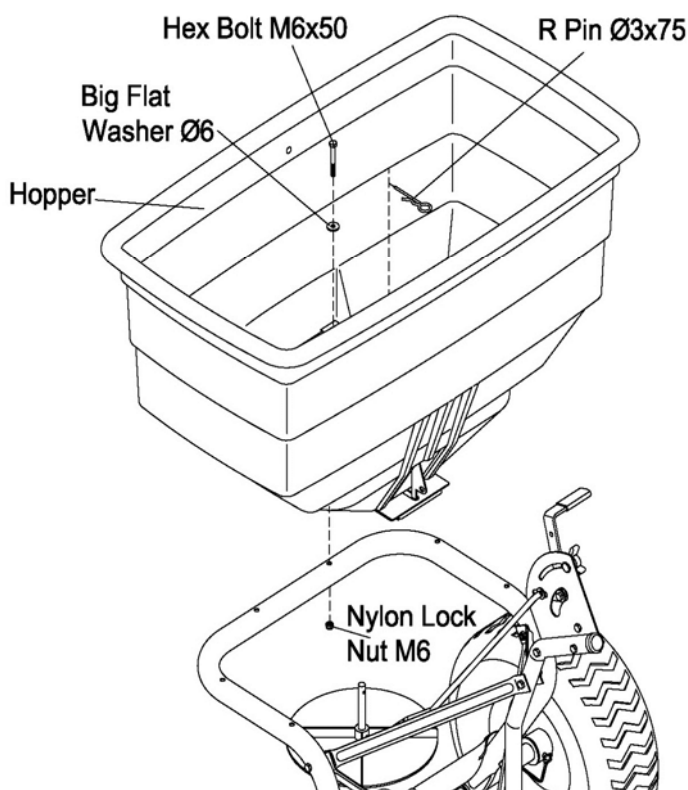

**STEP 8:** Install one flat washer Ø8 on the end of connection rod and insert into the hole on the rod base and secure using a nylon lock nut M8.

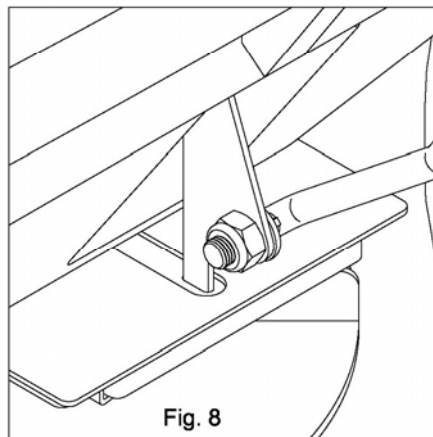
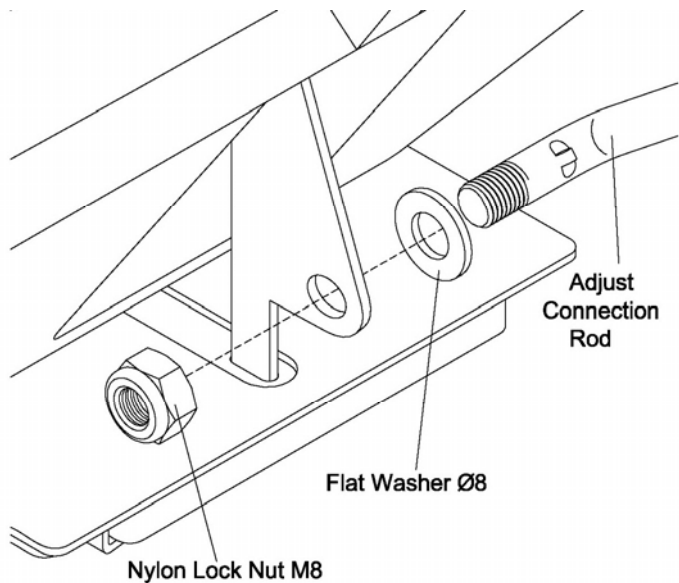

**STEP 9:** Attach the support rods to the hopper using the hex bolts M6x20, big flat washers Ø6 and nylon lock nuts M6.

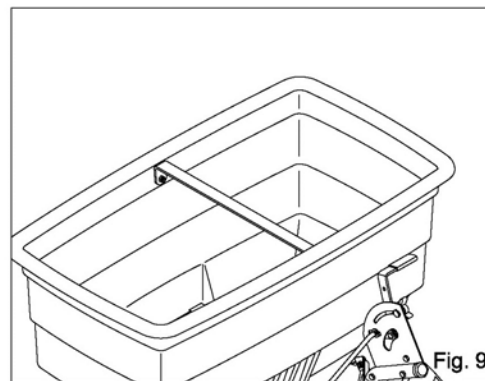
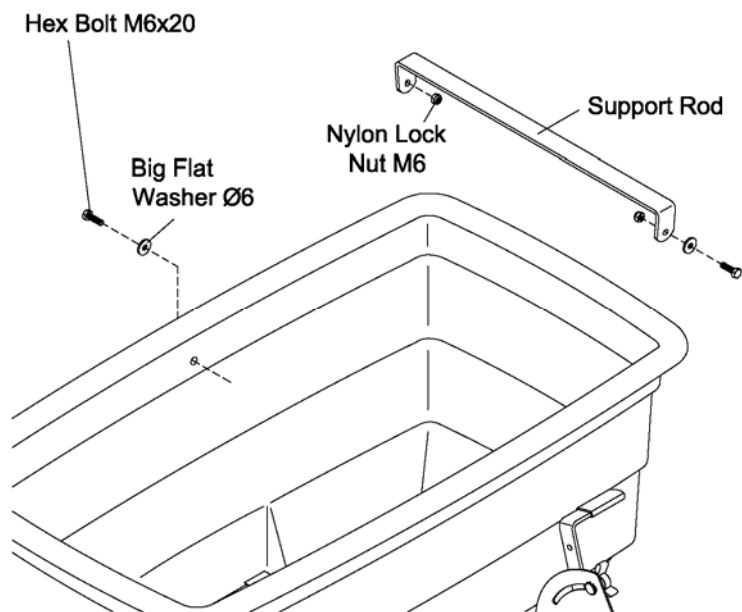

**STEP 10:** Insert the hopper screen into the bottom of the hopper.

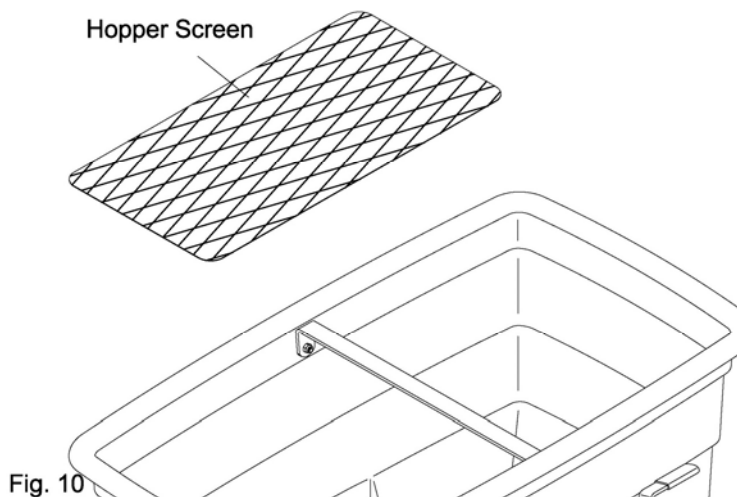

**STEP 11:** Connect hitch bracket to hitch tongue using the drive pin Ø9x60.

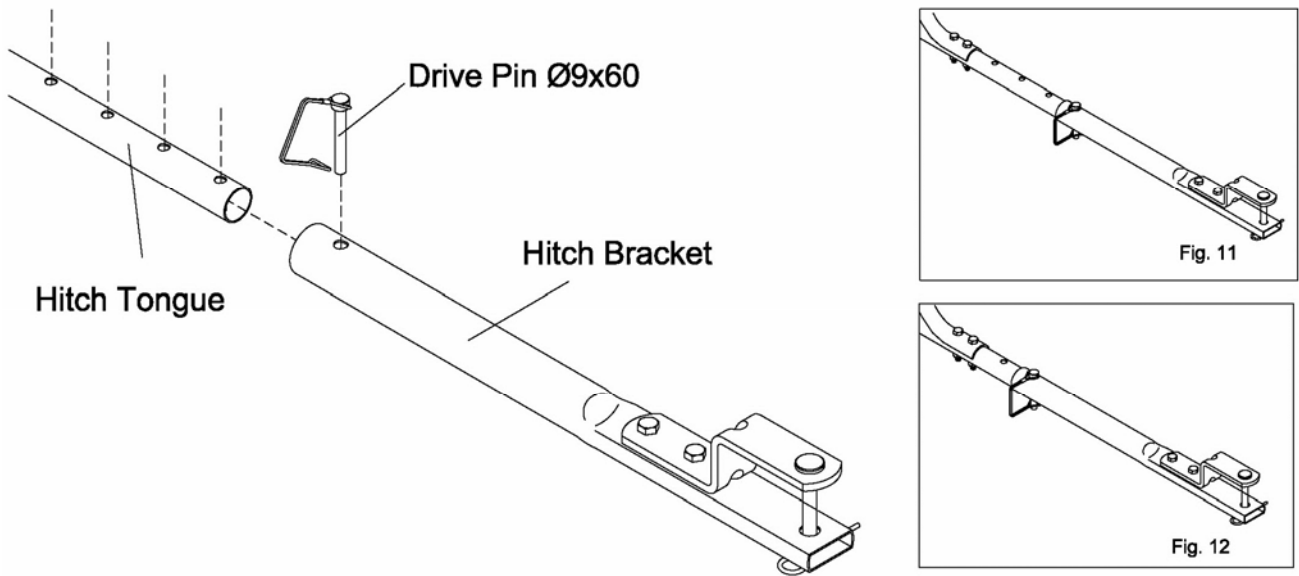

**NOTE:** Hitch Tongue is adjustable to different lengths.

**STEP 12:** Before operating the tow behind spreader make sure all hardware is securely tighten.

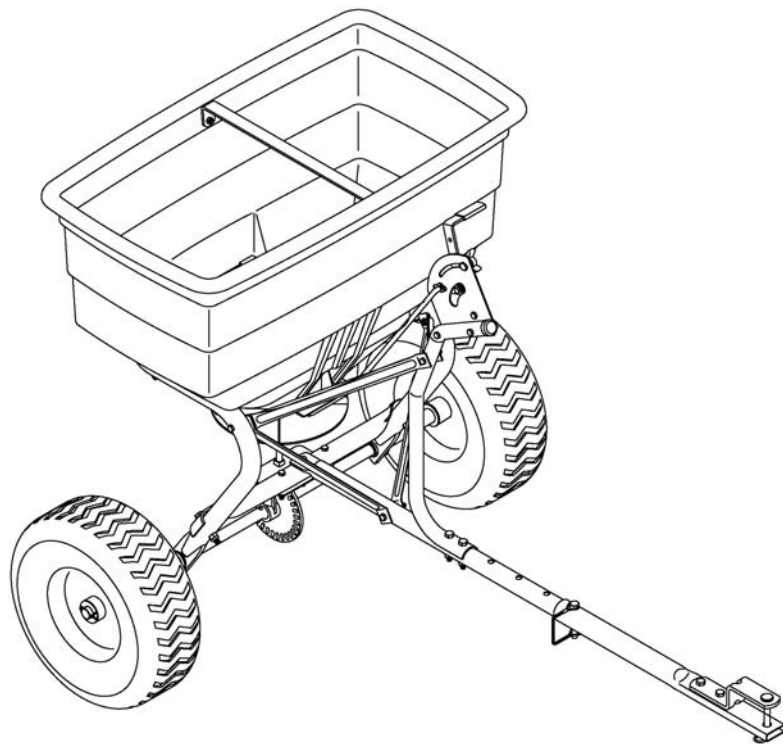

(\*) Push the adjustable handle on Gauge & Lever assembly to the proper setting while spreading.

(\*) Push the adjustable handle on Gauge & Lever assembly to the lowest position when stop spreading.



## **GENERAL WARNINGS**

Operator must read and understand all safety and warning information, operating instructions, maintenance and storage instructions before operating this equipment. Failure to properly operate and maintain the lawn roller could result in serious injury to the operator or bystanders.

### **Operation Warnings**

- Do not at any time carry passengers sitting or standing on the lawn roller.
- Do not allow children to play on, stand upon or climb on the spreader.
- Do not exceed rated capacity of 175lb
- Replace or repair damaged or worn parts immediately.
- To avoid personal injury and/or equipment damage **DO NOT EXCEED 5 MPH.**
- Only tow with recommended vehicles (Lawn/Garden Tractors and ATVs).
- Always inspect the spreader before using to assure it is in good working condition.
- Always keep hands and feet clear from moving parts while operating the equipment.
- **DO NOT** use if the spreader is damaged or worn as this may cause injury to the operator or bystanders.
- **ALWAYS** make sure the spreader is secure and locked to the hitch of the approved vehicle before operating.
- **Never** add material to the spreader unless it is attached to the tractor.

## **Maintenance and Storage**

### **MAINTENANCE**

- After each use clean material out of hopper.
- Rinse/dry inside and outside of the spreader after each use.
- Before operating make sure the tires have the **RECOMMENDED TIRE PRESSURE.**
- Periodically check all fasteners for tightness.
- Annually clean and lightly lubricate parts.
- Use a glossy enamel spray paint to touch up scratched or worn painted metal surfaces.
- Never exceed load capacity rating of 175lbs it will damage the spreader.

### **IMPORTANT:**

If a part needs replacement, only use parts that meet the manufacturer's specifications. Replacement parts that do not meet specifications may result in a safety hazard or poor operations.

### **STORAGE**

- Never allow material to remain in the hopper for extended periods of time.
- Before storing make sure the spreader is clean and dry for years of trouble free service.
- Store indoors or protected area during severe weather and winter months.

### **WARNING**

**ALWAYS** maintain the proper tire pressure. **DO NOT** over or under inflate the tires as serious injury may result. **ALWAYS** keep the tires at **20PSI.**



## PARTS LIST

Part#	Description	QTY	Part#	Description	QTY
1	Flat Washer Ø20	8	31	Control Rod	1
2	Pneumatic Tire	2	32	Hex Bolt M6x20	5
3	Wheel Spacer	2	33	Gauge Plate	1
4	Bushing	2	34	Big Flat Washer Ø6	18
5	Wheel Axle	1	35	Nylon Washer	1
6	Drive Gear	1	36	Handle Grip	1
7	Swivel Axle Base	1	37	Adjustable Handle	1
8	Pinion Gear	1	38	Wing Nut	1
9	Swivel Axle	1	39	Spacer	1
10	Pin Ø3x16	1	40	Connect Plate	1
11	Screw M4x20	1	41	Teeth Washer	1
12	Impeller	1	42	Carriage Bolt M6x25	1
13	Cotter Pin Ø4x40	2	43	Flat Washer Ø8	2
14	Pin Ø4x35	2	44	Swivel Axle Bushing	2
15	Drive Pin Ø6x45	1	45	Fixed Adjustable Plate	1
16	Hitch Support	4	46	Active Adjustbale Plate	1
17	Hex Bolt M6x45	5	47	Fix Plate for Control Rod	1
18	Hitch Tongue	1	48	Torsion Spring	1
19	Operation Support Rod	1	49	Base for Torsion Spring	1
20	Hex Bolt M8x45	4	50	Screen	1
21	Nylon Lock Nut M8	8	51	Support Rod	1
22	Hitch Bracket	1	52	Rivet	6
23	R Pin	2	53	Hex Bolt M6x50	7
24	Hitch Plate	1	54	Hopper	1
25	Hitch Pin	1	55	Hopper Frame	1
26	Hex Bolt M8x30	2	56	Crossover Tube	1
27	Drive Ø9x60	1	57	Swivel Axle Fix Plate	1
28	Nylon Lock Nut M6	21	58	Hex Bolt M6x40	2
29	End Cap	1	59	Rain Cover	1
30	Hex Bolt M6x35	1			

# Limited Warranty

## **Warranty**

For one year from the date of purchase YTL International will replace for the original purchaser, or repair the tow behind spreader. The warranty will not apply to any unit which was not assembled correctly, misused, overloaded or which has been used or operated contrary to our instructions, or which has been repaired or altered by anyone other than an authorized representative.

## **Warranty Exclusions**

This warranty does not cover cosmetic defects such as paint, decals or wear items such as tires. This warranty will not cover failures or problems due to acts of God, or events or forces beyond the control of the manufacturer.

## **Normal Wear Exclusion**

The spreader needs periodic service to perform well. This warranty does not cover repair when normal use has exhausted the life of a part or the equipment as a whole.

## **Installation, Use and Maintenance Exclusion**

This warranty will not apply to parts and/or labor if the push spreader has been misused, neglected, involved in an accident, abused, loaded beyond its limits, modified or assembled incorrectly. Normal maintenance is not covered under this warranty.

## **Limits of Implied Warranty and Consequential Damage Exclusion**

YTL International disclaims any obligation to cover any loss of time, use of this product, freight, or any incidental or consequential claim by anyone from using this push spreader. THIS WARRANTY IS IN LIEU OF ALL OTHER WARRANTIES, EXPRESS OR IMPLIED, INCLUDING WARRANTIES OF MERCHANTABILITY OR FITNESS FOR A PARTICULAR.

An exchange unit will be subject to the original warranty. The length of the warranty governing the exchanged unit will have the date as the purchase date of the original unit. This warranty gives you certain legal rights which may change from state to state. Your state may also have other rights you may be entitled to that are not listed within this warranty.

## **Contact Information**

YTL International  
17517 Fabrica Way, Suite H  
Cerritos, CA 90703  
Phone: (888) 723-6534  
Phone: (562) 404-8016  
Fax: (562) 404-8013